

# NIPISSING

U N I V E R S I T Y

North Bay, Ontario, Canada 

INTERNATIONAL  
ADMISSIONS  
2021

[nipissingu.ca/intl](http://nipissingu.ca/intl)



Right where  
you belong



**TOP 3**

in **STUDENT  
SATISFACTION**

in primarily undergraduate  
universities in Canada  
– *Maclean's* 2020



Find out why you belong at Nipissing!

Average  
Class Size  
**29**



- Small class sizes
- Supportive professors
- Safe, small, friendly community
- Best residences in Canada with private, single bedrooms
- #1 in Student Services – supporting your success
- The school is surrounded by nature, with beautiful hiking trails and a waterfall right on campus

*“As a student from India studying human resources at Nipissing, I have found the staff and faculty to be very warm, welcoming and accommodating to my needs. Nipissing is a multicultural community and I’m proud to be a part of it.”*  
– Suni C., Business Student

*Land acknowledgement: Nipissing University is situated in the territory of the Robinson-Huron Treaty of 1850, and the land on which we gather is the Nipissing First Nation Traditional Territory and the traditional territory of the Anishnabek.*

**51,553**  
population of  
North Bay  
(2016)



# Program Options

We have a variety of options to structure and customize your degree. For admissions requirements please see page 12. For a full list of program offerings, please visit [nipissingu.ca/programs](http://nipissingu.ca/programs)

Questions?  
Email  
[internationaladmiss@nipissingu.ca](mailto:internationaladmiss@nipissingu.ca)

## Undergraduate programs

- Anthropology
- Biology
- Business
  - Concentrations in: Accounting, Entrepreneurship and Innovation Leadership, Finance, Human Resources, International Business, and Marketing
- Child and Family Studies
- Classical Studies
- Commerce (only as a Dual Degree with BA or BSc)
- Computer Science
- Criminal Justice
  - Streams in: Corrections, Criminal Justice Studies, Criminology, and Policing
- Data Science **NEW!\***
- Economics
- English Studies
- Environment and Physical Geography
- Environmental Biology and Technology
- Environmental Geography
- Fine Arts
- Gender Equality and Social Justice
- Geography
- History
- Indigenous Studies
- Liberal Arts
- Liberal Science
- Mathematics
- Nursing
- Philosophy
- Physical and Health Education
- Political Science
- Psychology
- Religions and Cultures
- Social Welfare and Social Development
- Social Work
- Sociology

*\*For more information on our new Data Science program, please email [internationaladmiss@nipissingu.ca](mailto:internationaladmiss@nipissingu.ca)*

## Graduate and Professional Programs

- Bachelor of Education (Concurrent and Consecutive)
- Master of Arts (History)
- Master of Arts (Sociology)
- Master of Environmental Science
- Master of Environmental Studies
- Master of Science (Kinesiology)
- Master of Science (Mathematics)
- PhD in Education (Educational Sustainability)



*Nursing students not only have access to simulated learning labs on campus, but may have an opportunity to complete their experiential learning placements at the North Bay Regional Health Centre – a top tier hospital that is only a few minutes walk from residence and campus.*



# Program Options (continued)

## Dual Degrees

### Bachelor of Commerce Dual Degree

If you would like to combine Business with an Arts or Science program, Nipissing offers you the opportunity to study both and complete a Bachelor of Arts or Bachelor of Science degree with a Bachelor of Commerce degree in as little as five years. This dual degree allows you to study a wider range of general interest and career specific subjects. For admissions requirements, please see page 12. For more information on getting a dual degree, please contact the Recruitment Office at [nuinfo@nipissingu.ca](mailto:nuinfo@nipissingu.ca) or call (705) 474-3450 ext. 4200.

### Concurrent Education

Nipissing offers a 6-year concurrent program that leads to you earning both an honours undergraduate degree in your discipline of choice (except

Nursing and Social Work), and a Bachelor of Education degree. For further details visit [nipissingu.ca/education](http://nipissingu.ca/education)

## Second Degree Applicants

Students possessing an undergraduate degree may proceed to a second undergraduate degree program in another area of study. Students may be admitted to a second degree program if they hold a recognized university degree from an accredited university.

A second degree in Nursing may require the repeating of core credits taken in the first degree, if they are more than 10 years old.

*The Schulich School of Education at Nipissing University is a recognized leader in the field of teacher education. Renowned for graduating exceedingly well-prepared and professionally-minded teachers, the Schulich School will prepare you for teaching and provide you with transferable communication and collaborative skills that are essential to any career.*



For more details, visit  
[nipissingu.ca/schulich](http://nipissingu.ca/schulich)

## Post-Baccalaureate Diplomas (60 credits)

There are five Post-Baccalaureate Diplomas available to international students who have already graduated with a non-business undergraduate degree program from a recognized university. Students will build a foundation of general business knowledge and may specialize in one of the five areas.

Applicants must have a non-business bachelor's degree from a recognized university. At least six credits of university English and/or Communications (at a recognized English language university in an English speaking country) prior to admission or have met Nipissing University's English language proficiency requirements through the acceptable English language tests. The English/Communication courses and/or English language tests must have been completed within the two years prior to attending Nipissing University. Specific details about English language requirements can be found at [nipissingu.ca/englishproficiency](http://nipissingu.ca/englishproficiency)

### Post-Baccalaureate Diploma in Business Administration

Build your general business knowledge and skills through a broad set of courses including topics on commercial law, change management and business strategy.

### Post-Baccalaureate Diploma in Finance

Deepen your financial acumen through the study of topics including portfolio and wealth management, financial derivatives and risk management.

### Post-Baccalaureate Diploma in Human Resource Management

Compliment your study of business foundations with courses in recruitment, industrial relations and human resource planning.

### Post-Baccalaureate Diploma in International Business

Focuses on general business in an international context with courses about international marketing, management and finances.

### Post-Baccalaureate Diploma in Marketing

Build upon business foundation courses with a marketing focus with courses in consumer behaviour, communications, sports marketing and digital marketing.

## Post-Baccalaureate Certificates

### Post-Baccalaureate Certificate in Human Resources Management (33 credits)

This certificate is designed for applicants who wish to pursue the HRP/CHRP designation. Applicants will possess, at minimum, a three-year university degree for admission consideration.

### Post-Baccalaureate Certificate in General Management (30 credits)

This certificate is designed for graduates of non-business degree programs who wish to pursue business studies. Applicants will possess a non-business undergraduate degree for admission consideration.

*Enjoy interactive classes with caring,  
supportive professors.*





# Finance Your Education

International students entering the first year of a degree program at Nipissing University as full-time students in the fall term (September) will be considered automatically for the following entrance scholarships based on their best grades used for admission as long as an application for admission is received by **April 1**. Conditional offers of scholarships will go out with offers of admission. Scholarship eligibility will be reviewed once final grades are available.

Scholarship	Criteria*	Value
President's Scholarship	Equivalent to >90%	Domestic tuition; renewable at \$3000/yr
Carl Sanders Scholarship	Equivalent to >85%	\$2,500
Carl Sanders Scholarship	Equivalent to 80-84%	\$1,500
Schulich Education Scholarship	Entering first year with a focus on Education (Concurrent Education or Bachelor of Physical Health & Education or Consecutive Education); Minimum 80% admission average and at least one of financial need or demonstrated contributions to community	\$7,000

*Located in the heart of campus, the Harris Learning Library features naturally lit and large open spaces for studying, collaborating and connecting.*

*Hike to the falls on the trails from campus*

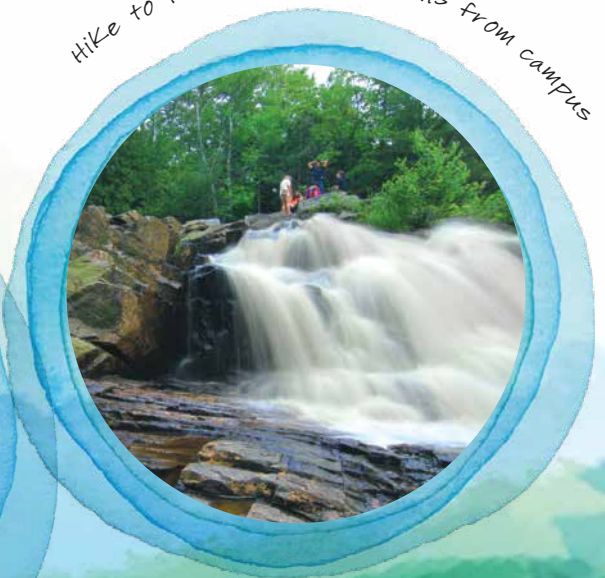

## International Work Study Program

The International Work-Study program provides part-time, on-campus employment to upper year international students who can prove financial need. International Work-Study is not intended to provide emergency funding; rather, it is to act as a supplement to a student's finances and to provide valuable on-campus employment which is allowed via Citizenship & Immigration Canada (CIC).

Contact the International Studies Office ([myinternational@nipissingu.ca](mailto:myinternational@nipissingu.ca)) for more information.

## Scholarships, Bursaries and Awards for Upper Year Students

Full-time, upper year (second year and higher) International students are eligible to be considered automatically for the following scholarships on the basis of their grades in 24 credits over the previous fall/winter. Note that students holding a President's scholarship cannot simultaneously hold a Carl Sanders Scholarship.

Scholarship	Criteria	Value
Carl Sanders Scholarship	>90%	\$1000
Carl Sanders Scholarship	85-89%	\$750
Carl Sanders Scholarship	80 - 84%	\$500
International Student Bursary	At least 2nd year of study with demonstrated financial need (must apply on the Web Bursary application posted on Web Advisor the month of October)	Variable

*There are a number of other donor-established bursaries and awards for which upper year international students may qualify; to be considered, please complete the Web Bursary application that is posted on WebAdvisor (Nipissing's online student portal) the month of October.*



## Create a financial plan

A plan helps you achieve your goals on time and on budget. This information is provided for guidance only. These are estimated based on 2020-2021 costs of living on campus for the 8-month academic term and are subject to change from year to year.

International Student Fees	Living Off Campus	Living in Residence
Tuition	\$19,325	\$19,325
Ancillary Fees (includes a City of North Bay transit pass)	\$1,944 <sup>Δ</sup>	\$1,944 <sup>Δ</sup>
Residence Accommodation	\$6,000 – \$9,000 <sup>‡</sup>	\$5,717 – \$6,425 <sup>†</sup>
Food	\$1,920	\$2,600*
Books and Supplies	\$500 – \$1,000	\$500 – \$1,000
Personal (does not include travel home)	\$1,700	\$1,700
<b>Total</b>	<b>\$31,389 – \$34,889</b>	<b>\$31,786 – \$32,994</b>

\* Optional meal plan included in above cost for example purposes is \$1100/term, plus an estimated \$400 for weekend eating out or groceries. For full details visit [dineoncampus.ca/nipissingcanadore](http://dineoncampus.ca/nipissingcanadore)

† Does not include refundable \$100 damage deposit.

‡ Off-campus housing costs are estimated based on a 12-month lease.

<sup>Δ</sup> Includes UHIP (University Health Insurance Plan) for International Students (\$60/month x 8 months = \$480.00); subject to change

- Optional on-campus parking (depending on lot): \$161 – \$255

Visit our online calculator for tuition and living expenses:

[nipissingu.ca/tuition](http://nipissingu.ca/tuition)



Students in the Bachelor of Physical and Health Education program.  
Left: Studying the movements of the human body using motion capture technology.  
Right: Learning to build a “quinzee” (snow shelter) in outdoor education.





# Residence

**#1** in  
**RESIDENCE LIVING**  
among universities  
in Canada  
- Maclean's 2020

Find out more about our top rated residences at [nipissingu.ca/residence](http://nipissingu.ca/residence)

## A private bedroom of your own

Our top-rated residences will make you feel right at home. You can count on making fast friends within your residence community, and enjoy the luxury of a private room of your own!

Our student leaders, Residence Dons and award-winning residence staff give tutorials on everything from the basics of laundry and cooking to making connections within the community. Our Community Assistants and Academic Dons are additional support for residents in each complex to help with a smooth transition into university.

For full details, visit [nipissingu.ca/residence](http://nipissingu.ca/residence)



sample layout

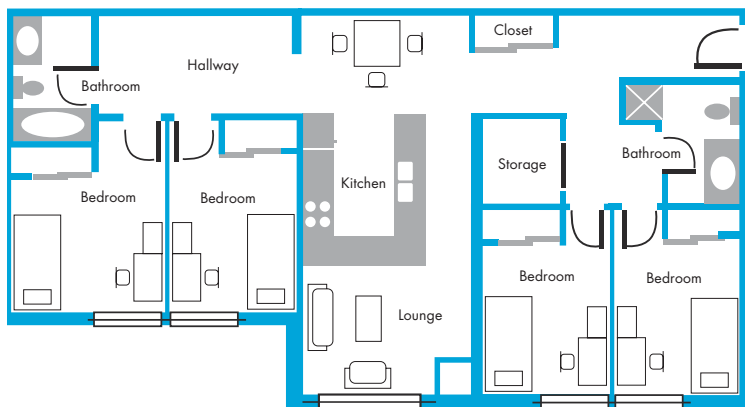

When the weather gets cold enough, the residence skating rink is flooded for students to skate for fun or play a friendly game of hockey!

**TOP 3**  
**STUDENT LIFE STAFF**  
in Canada  
- Maclean's 2020



# Student Support

You can count on our support – academically, culturally, financially and personally. Student Development and Services is an excellent resource that will help you maximize your success. For more information on our top rated support, please visit the following services:

## Academic Advising

[nipissingu.ca/academicadvising](http://nipissingu.ca/academicadvising)

Provides support to undergraduate students who wish to plan their programs or who need advice on any academic matter.

## Accessibility Services [nipissingu.ca/sas](http://nipissingu.ca/sas)

Supports students with permanent and temporary disabilities while striving to provide an accessible, barrier-free learning environment.

## Campus Health Centre

[nipissingu.ca/healthcentre](http://nipissingu.ca/healthcentre)

Provides quality services and health care delivery by a licensed physician and nurses available to all students.

## Enji giigdooyang, the Office of Indigenous Initiatives

[nipissingu.ca/indigenous](http://nipissingu.ca/indigenous)

Supports Indigenous Student Success through academic, personal and cultural programs offered.

## Equity Centre [equitycentrenu@nipissingu.ca](mailto:equitycentrenu@nipissingu.ca)

A student-run space on campus where students can hang out, learn, or help organize events that raise awareness of equity issues.

## International Initiatives

[nipissingu.ca/international](http://nipissingu.ca/international)

Provides support, programming and orientation to both international degree-seeking students and short-term exchange students who choose to study at Nipissing University.

## Multi-Faith Space Room H340

A quiet, comfortable place for prayer, meditation and reflection.

## Off Campus Living [ocl.nipissingu.ca](http://ocl.nipissingu.ca)

Designed to assist students with sourcing housing off campus and a resource for students to help with everyday living in the community.

## Sexual Violence Prevention and Education

[nipissingu.ca/sexualviolence](http://nipissingu.ca/sexualviolence)

Builds awareness about sexual and gender-based violence on campus and making the necessary supports accessible for those affected.

## Student Counselling [nipissingu.ca/counselling](http://nipissingu.ca/counselling)

Supports all students in achieving positive mental and emotional wellness.

## Student Intervention Support

[nipissingu.ca/nuperspective](http://nipissingu.ca/nuperspective)

Strives to create an environment that is free from violence and harassment, where students can be safe and feel secure.

## Student Learning and Transitions

[nipissingu.ca/slt](http://nipissingu.ca/slt)

A group of services and programs aimed at helping students engage in their academic studies and student life at Nipissing University.



## Student Exchange Opportunity

Applicants looking to participate in a student exchange at Nipissing University must first connect with their home institution about the application process. Partnering institutions for student exchange with Nipissing are responsible for the selection process of their eligible applicants, and a formal nomination is made by the applicant's home institution directly to the Nipissing International Initiatives Office. Once the nomination is received, the applicant will be contacted directly by the Nipissing International Initiatives Office to complete all necessary documentation.

For more information about the student exchange program at Nipissing visit:

[nipissingu.ca/international](http://nipissingu.ca/international) or email us at [myinternational@nipissingu.ca](mailto:myinternational@nipissingu.ca)



# How to Apply

Nipissing welcomes qualified applicants from outside of Canada to consider applying to degree programs at Nipissing University. Interested applicants must apply for admission through the Ontario Universities' Application Centre (OUAC) at [www.ouac.on.ca](http://www.ouac.on.ca) using the 105 application. Applications and all required official transcripts and applicable supplemental documentation are due by **April 1** for September admission consideration.

## Required Documentation

All secondary school transcripts should be sent directly to Nipissing University from the applicant's school and/or examination board. Documents not written in English must be accompanied by original notarized English translations from recognized sources. Applicants are required to declare and submit any and all postsecondary institutions attended or are currently attending. All postsecondary transcripts must be assessed (Credential Evaluation Report, including a Course-By-Course Analysis) by World Education Services ([www.wes.org/ca](http://www.wes.org/ca)).

## English Language Proficiency

All applicants to Nipissing University undergraduate degree programs from countries where the dominant language of instruction is other than English are required to demonstrate proficiency in English.

Specific details about English language requirements can be found at [nipissingu.ca/englishproficiency](http://nipissingu.ca/englishproficiency)

## International College or University Transfer Applicants

Applicants who have attended or are currently attending a recognized institution will be considered for admission based on their postsecondary studies. Program prerequisites must be met through previous secondary or previous/current postsecondary studies. Further information on prerequisite courses can be found in this brochure under Admission Requirements or at [www.nipissingu.ca/admissionschart](http://www.nipissingu.ca/admissionschart). Courses completed from a recognized institution may be eligible for transfer credit consideration. Transfer credits are assessed after applicants accept their offer of admission. Students possessing an undergraduate degree may be eligible for admission consideration to a second undergraduate degree program in another area of study.

Get more information  
on how to apply at:  
[nipissingu.ca  
/intl](http://nipissingu.ca/intl)

Questions?  
Email  
[internationaladmiss  
@nipissingu.ca](mailto:internationaladmiss@nipissingu.ca)



# Admission Requirements

The following are the minimum admission requirements for admission consideration to Nipissing University. Applicants are required to achieve a high overall standing in their studies and must include the appropriate program specific prerequisites depending on the degree program applied to. All applicants are considered on an individual basis. Meeting the minimum admission requirements does not guarantee admission.

	International Baccalaureate (IB)	American School System/ Advanced Placement (AP)	General Certificate of Education (GCE British Patterned Education)	International School Systems
<b>General Requirements</b>	Applicants who have completed the full International Baccalaureate (IB) diploma with at least six subjects, including three at the higher level, with a minimum grade total of 24 (not including bonus points) may be eligible for admission consideration. Transfer credit to a maximum of 30 credits may be granted for courses completed at the higher level with a grade of 5 or higher.	Applicants who have graduated with a "B" average from Grade 12 at an accredited high school may be eligible for admission consideration. Applicants must present SAT or ACT scores regardless of citizenship. Prerequisite subjects completed at the Freshman or Sophomore level are not acceptable. Transfer credit will be granted to a maximum of 18 credits for AP courses completed with a grade of 4 or better. Nipissing's SAT code is 4149 and ACT code is 5167.	Applicants who present a minimum of the General Certificate of Education (GCE) with satisfactory standing in at least five subjects, two of which must be at the advanced level, or satisfactory standing in at least four subjects, three of which must be at the advanced level may be eligible for admission consideration. Two Advanced Supplementary/Advanced Subsidiary (AS) subjects are considered equal to one Advanced Level subject for admissions purposes. Transfer credit may be awarded for A Level results. It is highly recommended that prerequisites be completed at the A Level.	Applicants possessing the requirements necessary for admission to a recognized university in their home country may be eligible for admission consideration. Prerequisite subjects must be met. All prerequisites should be completed at the senior secondary school level. Further information can be found at <a href="http://nipissingu.ca/internationaladmissions">nipissingu.ca/internationaladmissions</a> or by contacting <a href="mailto:internationaladmiss@nipissingu.ca">internationaladmiss@nipissingu.ca</a>

## Degree Requirements

Degree Program	OUAC Application Program Code	Subject of Major Interest	Required Courses			
			International Baccalaureate (IB)	American School System/ Advanced Placement (AP)	General Certificate of Education (GCE British Patterned Education)	International School Systems
<b>Bachelor of Arts (BA)</b>	PA	Anthropology, Child and Family Studies <sup>7,8,9</sup> , Classical Studies, English Studies, Environmental Geography <sup>2,4</sup> , Gender Equality and Social Justice, Geography <sup>2,4</sup> , History, Liberal Arts, Native Studies, Philosophy, Political Science, Psychology <sup>7,8,9</sup> , Religions and Cultures, Social Welfare and Social Development, Sociology	HL or SL English	Senior level English	English	English
		Economics	HL or SL English; HL or SL Mathematics	Senior level English; Senior level Mathematics	English; Mathematics	English; Mathematics
		Computer Science <sup>5</sup> , Mathematics <sup>5</sup>	HL or SL English; HL or SL Mathematics <sup>1</sup>	Senior level English; Senior Mathematics	English; Mathematics	English; Mathematics
	PAJ	Criminal Justice – Corrections; Criminal Justice Studies; Criminology; Policing streams	HL or SL English	Senior level English	English	English
	PAC	Social Welfare and Social Development with a Social Service Worker diploma	HL or SL English	Senior level English	English	English
	PAH	History with an Orientation to a Master of Arts in History	HL or SL English	Senior level English	English	English



# Degree Requirements

Degree Program	OUAC Application Program Code	Subject of Major Interest	Required Courses			
			International Baccalaureate (IB)	American School System/ Advanced Placement (AP)	General Certificate of Education (GCE British Patterned Education)	International School Systems
<b>Bachelor of Business Administration (BBA)<sup>6</sup></b>	PBA	Students select an area of concentration at the end of first year: Accounting, Entrepreneurship and Innovation Leadership, Finance, Human Resources, International Business, Marketing	HL or SL English (HL or SL Mathematics is recommended) <sup>1</sup>	Senior level English; (Senior level Mathematics) <sup>1</sup>	English (Mathematics recommended) <sup>1</sup>	English (Mathematics recommended) <sup>1</sup>
<b>Bachelor of Fine Arts</b>	PFA		HL or SL English	Senior level English	English	English
<b>Bachelor of Physical and Health Education</b>	PPE		HL or SL English; HL or SL Biology (HL or SL Chemistry and HL or SL Mathematics is recommended)	Senior level English; Senior or Junior level Biology (Senior or Junior level Chemistry and Senior level Mathematics is recommended)	English; Biology (Chemistry and Mathematics recommended)	English; Biology (Chemistry and Mathematics recommended)
<b>Bachelor of Science (BSc)</b>	PS	Biology <sup>3</sup>	HL or SL English; HL or SL Biology; HL or SL Chemistry; HL or SL Mathematics <sup>1</sup>	Senior level English; Senior level Mathematics; Senior or Junior level Biology and Chemistry	English; Biology; Chemistry; Mathematics	English; Biology; Chemistry; Mathematics
		Computer Science <sup>5</sup>	HL or SL English; HL or SL Mathematics <sup>11</sup> ; one of HL or SL Biology, HL or SL Chemistry or HL or SL Physics	Senior level English; Senior level Mathematics; one of Senior or Junior level Biology, Chemistry or Physics	English; Mathematics, one of Biology, Chemistry or Physics	English; Mathematics; one of Biology, Chemistry or Physics
		Liberal Science – Sequence in two of Biology, Computer Science, Environmental Science, Geology, or Mathematics	HL or SL English; two of HL or SL Chemistry, HL or SL Mathematics <sup>11</sup> or HL or SL Physics	Senior level English; two of Senior or Junior level Chemistry, Physics or Senior level Mathematics	English; two of Chemistry, Mathematics or Physics	English; two of Chemistry, Mathematics or Physics
		Mathematics <sup>5</sup>	HL or SL English; HL or SL Mathematics <sup>11</sup> ; one of HL or SL Biology, HL or SL Chemistry or HL or SL Physics	Senior level English; Senior level Mathematics; one of Senior or Junior level Biology, Chemistry or Physics	English; Mathematics; one of Biology, Chemistry or Physics	English; Mathematics; one of Biology, Chemistry or Physics
		Environmental Biology and Technology	HL or SL English; HL or SL Biology; HL or SL Chemistry; one of HL or SL Mathematics <sup>11</sup> or HL or SL Physics	Senior level English; Senior or Junior level Biology and Chemistry; one of Senior or Junior level Physics or Senior level Mathematics	English; Biology; Chemistry; one of Mathematics or Physics	English; Biology; Chemistry; one of Mathematics or Physics
		Environment and Physical Geography <sup>2,4</sup>	HL or SL English; HL or SL Mathematics; one of HL or SL Chemistry or HL or SL Physics	Senior level English; Senior level Mathematics; one of Senior or Junior level Chemistry or Physics	English; Mathematics; one of Chemistry or Physics	English; Mathematics; one of Chemistry or Physics
		Psychology <sup>3,7,8,9</sup>	HL or SL English; HL or SL Mathematics; one of HL or SL Biology; HL or SL Chemistry or HL or SL Physics	Senior level English; Senior level Mathematics; one of Senior or Junior level Biology, Chemistry or Physics	English; Mathematics; one of Biology, Chemistry or Physics	English; Mathematics; one of Biology, Chemistry or Physics
<b>Bachelor of Science in Nursing (BScN)</b>	PSN		HL or SL English; HL or SL Biology; HL or SL Chemistry (one HL or SL Mathematics is recommended)	Senior level English; Senior or Junior level Biology and Chemistry (Senior level Mathematics recommended)	English; Biology; Chemistry (Mathematics is recommended)	English; Biology; Chemistry (Mathematics is recommended)
<b>Bachelor of Social Work (BSW)<sup>10</sup></b>	PSW		HL or SL English (minimum grade of 4)	Senior level English (minimum grade of 70%)	English (minimum grade of C)	English (Minimum grade of 70% or equivalent)
<b>Bachelor of Arts (BA) or Bachelor of Science (BSc) combined with Bachelor of Commerce<sup>6</sup></b>	PAB, PSS		The regular requirements for the Bachelor of Arts (BA) or Bachelor of Science (BSc) major applied to.	The regular requirements for the Bachelor of Arts (BA) or Bachelor of Science (BSc) major applied to.	The regular requirements for the Bachelor of Arts (BA) or Bachelor of Science (BSc) major applied to.	The regular requirements for the Bachelor of Arts (BA) or Bachelor of Science (BSc) major applied to.

# Admission Requirements for Concurrent Education

Degree Program	OUAC Application Program Code	Subject of Major Interest	Required Courses			
			International Baccalaureate (IB)	American School System/ Advanced Placement (AP)	General Certificate of Education (GCE British Patterned Education)	International School Systems
<b>Concurrent Bachelor of Arts (BA)/Bachelor of Education (BEd)</b> <i>Primary/Junior Junior/Intermediate Intermediate/Senior</i>	PE, PEA, PEB	Child and Family Studies <sup>7,8,9</sup> , Classical Studies, English Studies, Environmental Geography <sup>2,4</sup> , Gender Equality and Social Justice, Geography <sup>2,4</sup> , History, Philosophy, Political Science, Psychology <sup>7,8,9</sup> , Religions and Cultures, Social Welfare and Social Development, Sociology	HL or SL English (minimum grade of 4); HL or SL Mathematics (minimum grade of 3)	Senior level English (minimum grade of 70%); Senior or Junior level Mathematics (minimum grade 60%)	English (minimum grade of C); Mathematics (minimum grade of D)	English (minimum grade of 70% or equivalent); Mathematics (minimum grade of 60% or equivalent)
		Computer Science <sup>5</sup> , Mathematics <sup>5</sup>	HL or SL English (minimum grade of 4); HL or SL Mathematics <sup>11</sup> **HL or SL Mathematics with a minimum grade of 3 is required for admission consideration to Concurrent Education	Senior level English (minimum grade of 70%); Senior level Mathematics **Senior or Junior level Mathematics with a minimum grade 60% is required for admission consideration to Concurrent Education	English (minimum grade of C); Mathematics (minimum grade of D)	English (minimum grade of 70% or equivalent); Mathematics (minimum grade of 60% or equivalent)
	PED, PEF, PEG	Criminal Justice - Corrections; Criminology; Policing streams	SL or HL English (minimum grade of 4); HL or SL Mathematics (minimum grade of 3)	Senior level English (minimum grade of 70%); Senior or Junior level Mathematics (minimum grade 60%)	English (minimum grade of C); Mathematics (minimum grade of D)	English (minimum grade of 70% or equivalent); Mathematics (minimum grade of 60% or equivalent)
<b>Concurrent Bachelor of Business Administration (BBA)<sup>6</sup>/ Bachelor of Education (BEd)</b> <i>Primary/Junior Junior/Intermediate Intermediate/Senior</i>	PEL, PEM, PEN	Students select an area of concentration at the end of first year: Accounting, Entrepreneurship and Innovation Leadership, Finance, Human Resources, International Business, Marketing	HL or SL English (minimum grade of 4); HL or SL Mathematics (minimum grade of 3)	Senior level English (minimum grade of 70%); Senior or Junior level Mathematics (minimum grade 60%) (Senior level Mathematics is recommended) <sup>1</sup>	English (minimum grade of C); Mathematics (minimum grade of D)	English (minimum grade of 70% or equivalent); Mathematics (minimum grade of 60% or equivalent)
<b>Concurrent Bachelor of Fine Arts (BFA)/ Bachelor of Education (BEd)</b> <i>Primary/Junior Junior/Intermediate Intermediate/Senior</i>	PEH, PEI, PEK		SL or HL English (minimum grade of 4); SL or HL Mathematics (minimum grade of 3)	Senior level English (minimum grade of 70%); Senior or Junior level Mathematics (minimum grade 60%)	English (minimum grade of C); Mathematics (minimum grade of D)	English (minimum grade of 70% or equivalent); Mathematics (minimum grade of 60% or equivalent)
<b>Concurrent Bachelor of Physical and Health Education (BPHE)/ Bachelor of Education (BEd)</b> <i>Primary/Junior Junior/Intermediate Intermediate/Senior</i>	PEO, PEQ, PER		HL or SL English (minimum grade of 4); HL or SL Mathematics (minimum grade of 3); HL or SL Biology (HL or SL Chemistry is recommended)	Senior level English (minimum grade of 70%); Senior or Junior level Mathematics (minimum grade 60%); Senior or Junior level Biology (Senior or Junior level Chemistry is recommended)	English (minimum grade of C); Mathematics (minimum grade of D); Biology (Chemistry recommended)	English (minimum grade of 70% or equivalent); Mathematics (minimum grade of 60% or equivalent); Biology (Chemistry recommended)

1 Students admitted without the recommended Mathematics will be required to complete MATH 1911 or MATH 1912 in their first year.

2 A Certificate in Geomatics is also available to pursuing an Honours degree in these areas.

3 A Certificate in Neuroscience is also available to pursuing an Honours degree in these areas.

4 A Certificate in Environmental Management is also available to pursuing an Honours degree in these areas.

5 A Certificate in Game Design and Development is available to students pursuing a degree in these areas.

6 An iLEAD Business Experience Certificate is available to students pursuing one of these degrees.

7 A Certificate in Applied Behaviour Analysis (ABA) – Lifespan is available to students pursuing an Honours Specialization, Specialization or a Major in these areas.

8 A Certificate in Applied Early Intensive Behaviour Intervention (EIBI) – Autism Spectrum Disorder (ASD) is available to students pursuing an Honours Specialization, Specialization or a Major in these areas.

9 A Certificate in Program Evaluation and Applied Research (PEAR) is available to students pursuing an Honours Specialization, Specialization or a Major in these areas.

10 During Year 2 of the Bachelor of Social Work program, students must apply for admission consideration to the professional years (Years 3 & 4) of the program. Admission to the first or second year of the Bachelor of Social Work program does not guarantee acceptance into the professional years.

11 Mathematical Studies is not acceptable.

The following certificates are available to all students pursuing any degree:

Archaeological Monitoring  
Bilingualism  
Digital Classics  
Digital Humanities  
Forest Resource Management and Conservation

Health Studies and Gerontology  
Indigenous Leadership  
Peace and Violence Prevention  
Study of State Violence (War, Atrocity, and Genocide)



## Admission Requirements for Concurrent Education (continued)

Degree Program	OUAC Application Program Code	Subject of Major Interest	Required Courses			
			International Baccalaureate (IB)	American School System/ Advanced Placement (AP)	General Certificate of Education (GCE British Patterned Education)	International School Systems
<b>Concurrent Bachelor of Science (BSc)/Bachelor of Education (BEd)</b>  <i>Primary/Junior Junior/Intermediate Intermediate/Senior</i>	PES, PET, PEU	Biology <sup>3</sup>	HL or SL English (minimum grade of 4); HL or SL Biology; HL or SL Chemistry; HL or SL Mathematics <sup>11</sup> **HL or SL Mathematics with a minimum grade of 3 is required for admission consideration to Concurrent Education	Senior level English (minimum grade of 70%); Senior or Junior level Biology and Chemistry; Senior level Mathematics **Senior or Junior level Mathematics with a minimum grade 60% is required for admission consideration to Concurrent Education	English (minimum grade of C); Biology; Chemistry; Mathematics (minimum grade of D)	English (minimum grade of 70% or equivalent); Biology; Chemistry; Mathematics (minimum grade of 60% or equivalent)
		Computer Science <sup>5</sup>	HL or SL English (minimum grade of 4); HL or SL Mathematics <sup>11</sup> ; one of HL or SL Biology, HL or SL Chemistry or HL or SL Physics **HL or SL Mathematics with a minimum grade of 3 is required for admission consideration to Concurrent Education	Senior level English (minimum grade of 70%); Senior level Mathematics; one of Senior or Junior level Biology, Chemistry or Physics **Senior or Junior level Mathematics with a minimum grade 60% is required for admission consideration to Concurrent Education	English (minimum grade of C); Mathematics (minimum grade of D); one of Biology, Chemistry or Physics	English (minimum grade of 70% or equivalent); Mathematics (minimum grade of 60% or equivalent); one of Biology, Chemistry or Physics
		Mathematics <sup>5</sup>	HL or SL English (minimum grade of 4); HL or SL Mathematics <sup>11</sup> ; one of HL or SL Biology, HL or SL Chemistry or HL or SL Physics **HL or SL Mathematics with a minimum grade of 3 is required for admission consideration to Concurrent Education	Senior level English (minimum grade of 70%); Senior level Mathematics; one of Senior or Junior level Biology, Chemistry or Physics **Senior or Junior level Mathematics with a minimum grade 60% is required for admission consideration to Concurrent Education	English (minimum grade of C); Mathematics (minimum grade of D); one of Biology, Chemistry or Physics	English (minimum grade of 70% or equivalent); Mathematics (minimum grade of 60% or equivalent); one of Biology, Chemistry or Physics
		Environmental Biology and Technology	HL or SL English (minimum grade of 4); HL or SL Biology; HL or SL Chemistry; one of HL or SL Mathematics <sup>11</sup> or HL or SL Physics **HL or SL Mathematics with a minimum grade of 3 is required for admission consideration to Concurrent Education	Senior level English (minimum grade of 70%); Senior or Junior level Biology and Chemistry; one of Senior or Junior level Physics or Senior level Mathematics **Senior or Junior level Mathematics with a minimum grade 60% is required for admission consideration to Concurrent Education	English (minimum grade of C); Biology; Chemistry; one of Mathematics or Physics **Mathematics with a minimum grade of D is required for admission consideration to Concurrent Education	English (minimum grade of 70% or equivalent); Biology; Chemistry; one of Mathematics or Physics **Mathematics with a minimum grade of 60% or equivalent is required for admission consideration to Concurrent Education
		Environment and Physical Geography <sup>2,4</sup>	HL or SL English (minimum grade of 4); HL or SL Mathematics (minimum grade of 3); one of HL or SL Chemistry or HL or SL Physics	Senior level English (minimum grade of 70%); Senior level Mathematics; one of Senior or Junior level Chemistry or Physics **Senior or Junior level Mathematics with a minimum grade 60% is required for admission consideration to Concurrent Education	English (minimum grade of C); Mathematics (minimum grade of D); one of Chemistry or Physics	English (minimum grade of 70% or equivalent); Mathematics (minimum grade of 60% or equivalent); one of Chemistry or Physics
		Psychology <sup>3,7,8,9</sup>	HL or SL English; HL or SL Mathematics (minimum grade of 3); one of HL or SL Biology; HL or SL Chemistry or HL or SL Physics	Senior level English (minimum grade of 70%); Senior level Mathematics; one of Senior or Junior level Biology, Chemistry or Physics **Senior or Junior level Mathematics with a minimum grade 60% is required for admission consideration to Concurrent Education	English (minimum grade of C); Mathematics (minimum grade of D); one of Biology, Chemistry or Physics	English (minimum grade of 70% or equivalent); Mathematics (minimum grade of 60% or equivalent); one of Biology, Chemistry or Physics

North Bay is about a 3.5 or 4 hour drive from Toronto and Ottawa

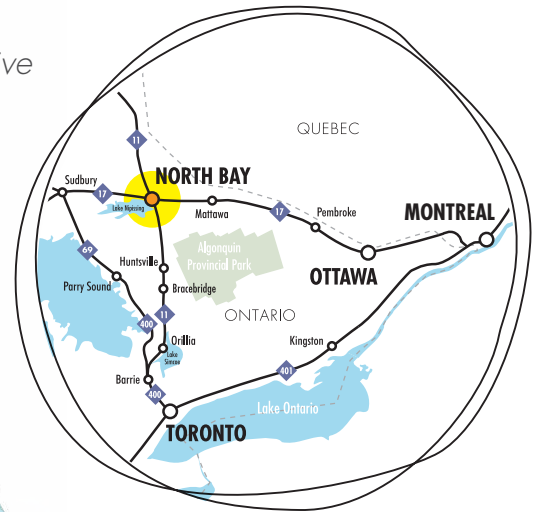

[www.nipissingu.ca/intl](http://www.nipissingu.ca/intl)  
[internationaladmiss@nipissingu.ca](mailto:internationaladmiss@nipissingu.ca)



**NIPISSING**  
UNIVERSITY

ONE STUDENT AT A TIME

Student Recruitment Office • 100 College Drive, Box 5002, North Bay, ON P1B 8L7

tel: (705) 474-3450 ext. 4200 • tty: (877) 688-5507 • fax: (705) 495-1772

[www.nipissingu.ca/intl](http://www.nipissingu.ca/intl) • [internationaladmiss@nipissingu.ca](mailto:internationaladmiss@nipissingu.ca)

[facebook.com/NURecruitment](https://www.facebook.com/NURecruitment) • [@NipissingU](https://www.instagram.com/NipissingU) @NURecruitment

If you would like to request this publication in an alternative format please contact the Student Recruitment Office at (705) 474-3450 ext. 4200